

General Purpose, Fast, Super Fast, Ultra Fast and Schottky Rectifiers

SOD-123F

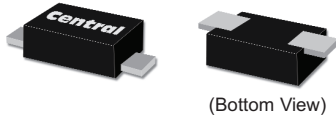

(Bottom View)

features

- 1.0 Amp average forward current
- Improved thermal efficiency
- Space saving SOD-123F package (50% smaller than SMA)

description

The latest family of Central Semiconductor rectifiers include: 1 Amp General Purpose (CMMR1), 1 Amp Fast Recovery (CMMR1F), 1 Amp Superfast (CMMR1S), 1 Amp Ultrafast (CMMR1U), and 1 Amp Schottky (CMMSH1) devices.

These rectifiers are designed for a wide range of applications requiring a small surface mount package. The SOD-123F flat lead package can accommodate a 1 Amp chip for high current handling and improved thermal efficiency.

Sample Devices
available
upon request.

selection guide

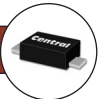

	General Purpose	Fast	Ultra Fast	Super Fast
I_O (AMPS)	1.0			
@ T_L (°C)	75	90	90	110
I_{FSM} (AMPS)	30	30	30	30
CASE	 SOD-123F			
V_{RRM} (VOLTS)				
200	CMMR1-02	CMMR1F-02	CMMR1U-02*	CMMR1S-02
400	CMMR1-04	CMMR1F-04	CMMR1U-04*	–
600	CMMR1-06	CMMR1F-06	CMMR1U-06*	–
1000	CMMR1-10	–	–	–
V_F MAX @ $I_F = I_O$	1.1V	1.3V	U-02: 1.0V U-04: 1.25V U-06: 1.4V	0.95V
I_R MAX @ V_{RRM}	10 μ A	10 μ A	10 μ A	10 μ A
t_{rr} (200V)	–	150ns	35ns	35ns
t_{rr} (400V)	–	150ns	50ns	–
t_{rr} (600V)	–	250ns	75ns	–

* Please Consult Factory

	Schottky
I_O (AMPS)	1.0
@ T_L (°C)	75
I_{FSM} (AMPS)	30
CASE	 SOD-123F
V_{RRM} (VOLTS)	
20	CMMSH1-20
40	CMMSH1-40
60	CMMSH1-60
100	CMMSH1-100
V_F MAX @ $I_F = I_O$	
CMMSH1-20	0.45V
CMMSH1-40	0.55V
CMMSH1-60	0.70V
CMMSH1-100	0.85V
I_R MAX @ V_{RRM}	500 μ A

General Purpose, Fast, Super Fast, Ultra Fast and Schottky Rectifiers

Mechanical Specifications - SOD-123F

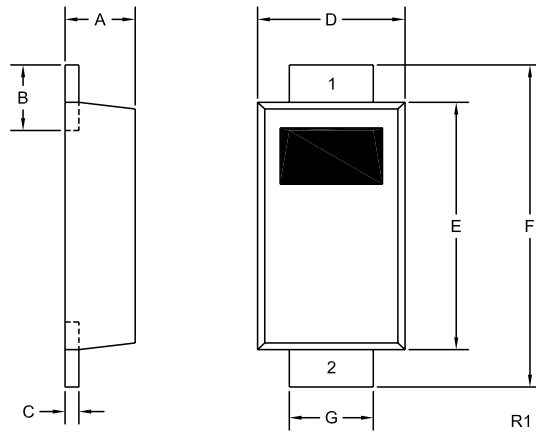

SYMBOL	INCHES		MILLIMETERS	
	MIN	MAX	MIN	MAX
A	0.035	0.043	0.88	1.08
B	0.020	0.031	0.50	0.80
C	0.004	0.008	0.10	0.20
D	0.065	0.077	1.65	1.95
E	0.104	0.116	2.65	2.95
F	0.140	0.156	3.55	3.95
G	0.030	0.041	0.75	1.05

SOD-123F (REV:R1)

Mounting Pad Geometry (Dimensions in mm)

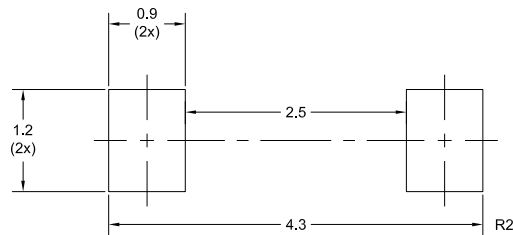

Tape Dimensions and Orientation (Dimensions in mm)

Tape Width: 8mm

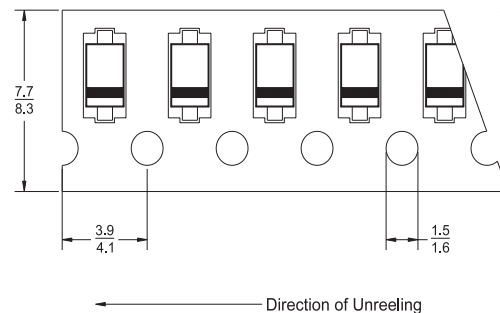

* Devices are taped in accordance with Electronic Industries Association Standard EIA-481-1-A

Size Comparison

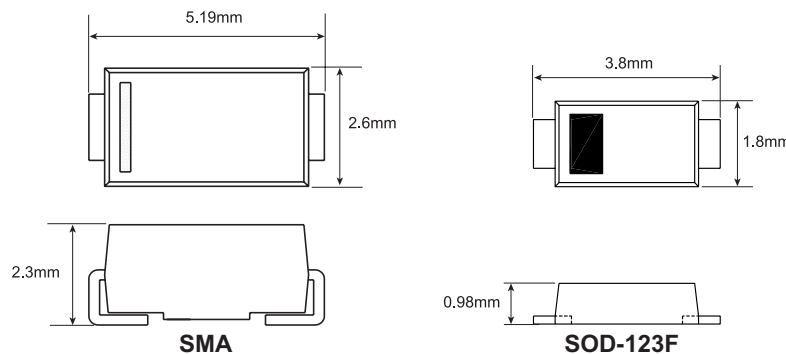

CentralTM
Semiconductor Corp.

*Innovations in Discrete
Semiconductors*

For further information contact:
Sales at Central Semiconductor Corp.
(631) 435-1110 or visit our website at:
www.centalsemi.com

145 Adams Avenue • Hauppauge • New York • 11788 • USA • Tel:(631) 435-1110 • Fax:(631) 435-1824

PA CMMR1 Series